

Sheridan College

SOURCE: Sheridan Institutional Repository

Paisley Mill

Architecture - Studio 6 Project

Winter 2022

Mary Abuelfarag

Mary Abuelfarag
Sheridan College

Follow this and additional works at: https://source.sheridancollege.ca/student_work_fast_projects_studio6_paisley_mill



Part of the [Architectural Technology Commons](#), and the [Interior Architecture Commons](#)

SOURCE Citation

Abuelfarag, Mary, "Mary Abuelfarag" (2022). *Paisley Mill*. 32.

https://source.sheridancollege.ca/student_work_fast_projects_studio6_paisley_mill/32



This work is licensed under a [Creative Commons Attribution-Noncommercial-No Derivative Works 4.0 License](#). This Student Work is brought to you for free and open access by the Architecture - Studio 6 Project at SOURCE: Sheridan Institutional Repository. It has been accepted for inclusion in Paisley Mill by an authorized administrator of SOURCE: Sheridan Institutional Repository. For more information, please contact source@sheridancollege.ca.

MP2.C - 3D WALL SECTION

PROJECT BY: MARY ABUELFARAG
STUDIO 6 (ARCH34231)



MARY MAHER
DESIGNS

WALLS

W1- EXTERIOR WALL ASSEMBLY

- 51mm Brick Finishing
- 76mm Z-Grits w/ 50mm RSI (R-12) Rigid Insulation
- 50mm Air space
- 1 Layer Blueskin VP160 Self-Adhering Membrane
- 16mm Exterior Grade Gypsum Sheathing
- 152 Steel Studs @ 300mm O.C w/ RSI 3.34 (R-19) Batt Insulation
- 6mil Polyethylene Vapour Barier
- 2 Layers of 15.9mm Type X Sheetrock Firecode C Core Gypsum Panel
- Wall Finish as per Room Schedule

FND - TYPICAL FOUNDATION WALL

- 200mm Cast-in-Place Concrete Wall
- Waterproofing
- 19mm Mineral Fibre

MISC DETAILS

- 1-Suspended Ceiling
- 2-Front Porch/Ramp
- 3-Weep Hole
- 4-Sinage
- 5-Strip Foundation

DESIGN INTENT

The design intent behind this 3D section is to demonstrate all the many cladding assemblies and how they connect to one another. The section cuts through the main entrance and following up to the floors above it. This building was originally built with old timber structure, with the adaptive reuse the structure was replaced with steel to help create a more modern look. Modernizing the building will aid in improving the goal usage of the space, health, and wellness center. The clean look of the interior spaces helps to relax the mind, to really feel like you are able to utilize the facilities of the center and feel calm and refreshed. The exterior brick finishing, not only being aesthetically pleasing, it's also low maintenance, simple which fits into the concept of the wellness center. Overall, the section was strategically chosen to be able to demonstrate the most important utilities of the center, as well as inspire comfortability and quality on behalf of The Wellness Center.

ROOF

R1-FLAT ROOF ASSEMBLY

- 4 Ply Built-Up
- Asphalt Protection Board
- 1 Layer Of 76mm Rigid Insulation & 1 Layer Of 83mm ISO 95
- 6mil Polyethylene Vapour Barrier
- Metal Deck On OWSJ

FLOORS

F1- FLOOR AT GRADE

- 13mm Plaster Finished Floor
- 25mm Subsheeling
- 50mm Rigid Insulation
- Vapour Barrier
- 152mm Cast in Place Concrete
- 38mm Metal Deck
- Drop Ceiling

F2- INTERIOR FLOOR

- 13mm Wood Finish Floor
- 25mm Subsheeling
- 50mm Rigid Insulation
- 152- Cast in Place Concrete
- 38mm Metal Deck
- Drop Ceiling

KEY PLAN

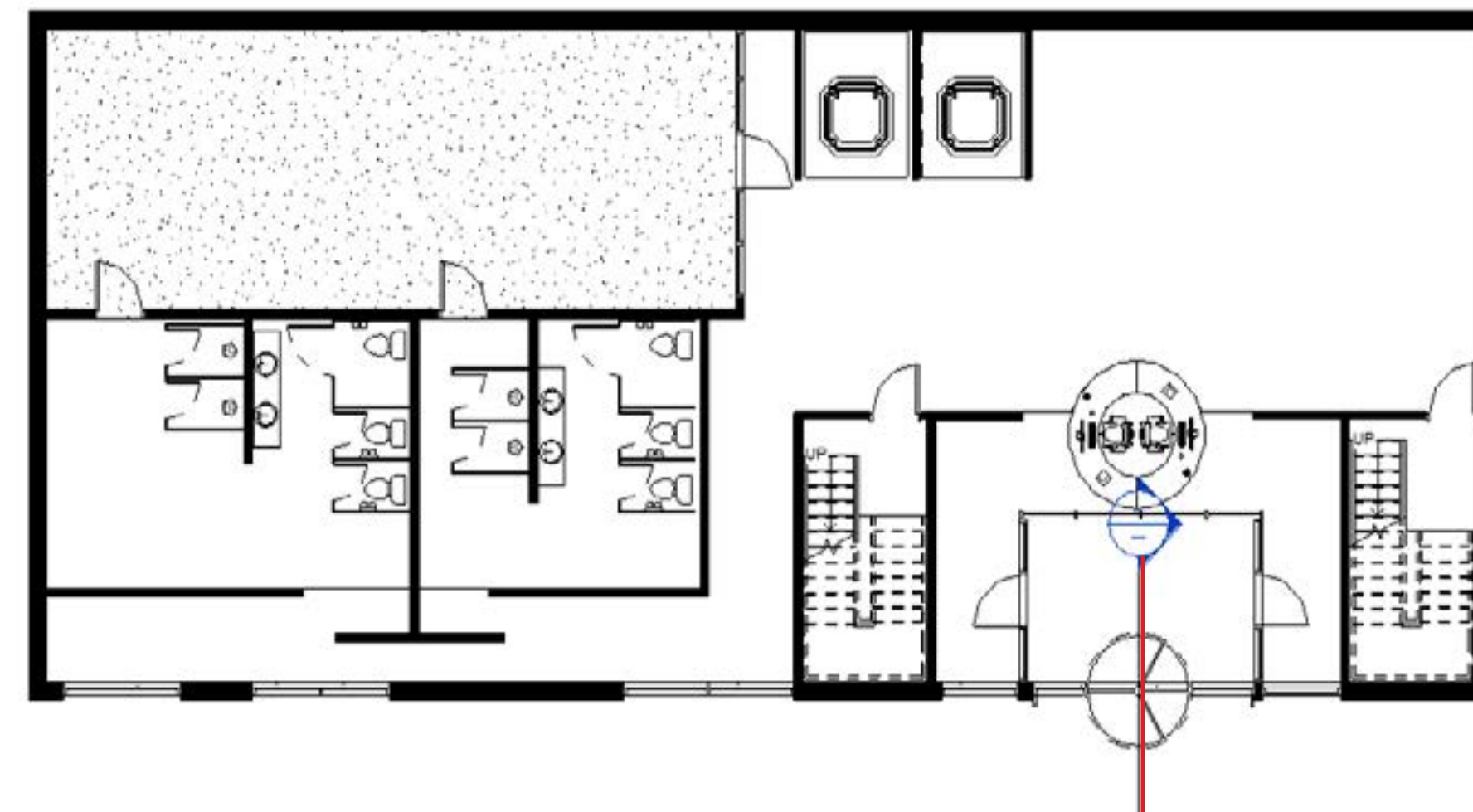

T/O OF ROOF - 15550

U/S OF ROOF - 14550

FOURTH FLOOR - 11080

THIRD FLOOR - 7880

SECOND FLOOR - 4150

MAIN FLOOR - 500

T/O OF GRADE - 0

